

● Option units



● Specification <DS-8100>

1. Configuration

Main unit configuration

DS-8100N	Main unit
DS-8100M	Main unit

※N = SpO2 Nellcor technologies unit, M = SpO2 Masimo technologies unit

Printer unit (optional)

HR-810	3ch printer
--------	-------------

Extension port unit (optional)

CU-810	Analogue and VGA outputs, DS-8500 communication capability
--------	------------------------------------------------------------

Printer/Extension port unit (optional)

HR-811	3ch printer, analogue and VGA outputs, DS-8500 communication capability
--------	-------------------------------------------------------------------------

Gas unit (optional)

HPD-810	Gas unit I/F (mainstream)
HCP-810	CO2 gas unit (sidestream)

Others (optional)

HLX-801	Telemeter module
HTC-702	T-CON module
BTO-008	Battery

Dimension and weight

DS-8100N	300(W) × 265(H) × 75(D)mm / 3.5Kg
DS-8100M	300(W) × 265(H) × 75(D)mm / 3.5Kg
HR-810	100(W) × 110(H) × 178(D)mm / 0.65Kg
CU-810	45(W) × 110(H) × 178(D)mm / 0.40Kg
HR-811	100(W) × 110(H) × 178(D)mm / 0.75Kg
HPD-810	36(W) × 91(H) × 87(D)mm / 0.18Kg
HCP-810	36(W) × 91(H) × 87(D)mm / 0.22Kg
HTC-702	158(W) × 78(H) × 27(D)mm / 0.27kg
HLX-801	41(W) × 93(H) × 16(D)mm / 0.06kg

2. Specification

Displayed waveforms	ECG, RESP, Pulse, IBP and EtCO2
Displayed parameters	HR, ST and arrhythmia SpO2 and PR NIBP (SYS, DIA, MAP, Cuff pressure and PR) IBP (SYS, DIA, MAP and PR) Maximum 2 channels CO (Cardiac Output) Temperature Maximum 4 channels EtCO2 (mainstream or sidestream) OCRG function PI (DS-8100M only) SpMet, SpCO, SpHb, PVI (DS-8100M only) (optional)
Display	10.2 inch wide colour LCD
Resolution	WSVGA(1024×600)
Number of displayed waveforms	Up to 14 waveforms
Printing method	Thermal printing method
Printing paper width	50mm
Waveforms/recording	Maximum 3 waveforms per recording
Printing sweep speed	50/25mm/S
AC power	AC100-240V 50/60Hz
AC consumption	60VA
Battery usage time	3 hours (NIBP set to 15min interval, no option unit used)
Battery charging time	Quick charging time 4 hours approximately (without operation) Normal charging time 8 hours approximately (with operation)

DYNASCOPE

Bedside monitor
DS-8100 Series



“Monitoring Made Simple”

Compact Lightweight Powerful.

DYNASCOPE
compact and smart great flexibility
NIBP Best set-up spec for multi param hospital environment or nursing style. patient monitors
10.2 inch Wide Color Display

DYNASCOPE
DS-8100

"Monitoring Made Simple"

Compact and ultra slim, designed to fit every critical area.

The DS-8100 includes a wide colour 10.2 inch LCD in its compact body.
It can be customised to meet the demands of any critical care environment.

DYNASCOPE
compact and smart
NIBP Best set-up spec for m
hospital environment or nursing sty
10.2 inch Wide Color Display



compact

A wider display screen in a compact body

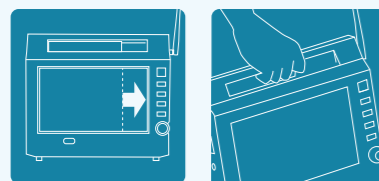

Wide Screen display for longer waveform tracing, lightweight and robust for easy transport with optional pole or bed mounting kit.

interface

A better and easier user interface

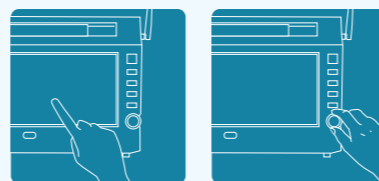

Settings are quickly and easily activated either via the touch screen or the jog dial. Depending on the situation, the screen configuration, menus and windows are all used to provide simple and effective monitoring.

option

Optional units mean it can be customised for every clinical application.

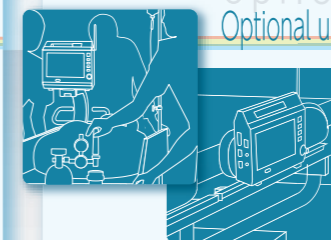

In case EtCO₂ is needed,



Sidestream unit HCP-810
Mainstream unit HPD-810

In case printing is needed,



Printing unit HR-810